

Grade 8

DIRECTIONS:

This section is made up of math problems. Read each problem carefully and then mark your answer on the answer sheet. A sample problem is shown below.

Math Computation Sample S1

S1. If $5(x + 3) = 25$, then $x =$

- A. 10
- B. 5
- C. 2
- D. 1

The correct answer is C. Find Math Computation Sample S1 on your answer sheet. Fill in the circle with the letter C as shown below.

S1. (A) (B) ● (D)

- ▲ You will have **40 MINUTES** to complete the problems in this section.
- ▲ You may write _____ on scratch paper, but you must mark your answers on the answer sheet.
- ▲ There is only one correct answer for each problem.
- ▲ If you change your mind about an answer, erase it and fill in the new one.
- ▲ Do not spend too much time on any one problem. Work on as many problems as you can.
- ▲ You may **not** use a calculator to solve the problems.
- ▲ Mark your answers on the section of the answer sheet that says **MATH COMPUTATION**.

Do you have any questions?



DO NOT TURN THE PAGE UNTIL YOU ARE TOLD TO DO SO.

8

1. $399 \div 19 =$

- A. 19
- B. 21
- C. 38
- D. 7,581

2. $50^2 =$

- A. 25
- B. 100
- C. 2,500
- D. 5,000

3. Simplify.

$8 \div 2 + 3(2)$

- A. 0.8
- B. 10
- C. 14
- D. 32

4. $38.845 \div 0.85 =$

- A. 4.57
- B. 45.7
- C. 457
- D. 4,570

5. $23 \times 111 \times 246 =$

- A. 2,553
- B. 2,799
- C. 27,306
- D. 628,038

6. $5 \times \frac{1}{8} =$

- A. $\frac{1}{40}$
- B. $\frac{5}{40}$
- C. $\frac{5}{8}$
- D. 40

7. $5 + 5\frac{1}{2} =$

- A. $\frac{10}{2}$
- B. $\frac{11}{2}$
- C. $5\frac{1}{2}$
- D. $10\frac{1}{2}$

8. $14^3 =$

- A. 42
- B. 2,744
- C. 14,000
- D. 38,416

9. $\sqrt{49} =$

- A. 7
- B. 8
- C. 9
- D. 14

10. 2 is a square root of which number?

- A. 1
- B. 2
- C. 4
- D. 22

11. 10 is a square root of which number?

- A. 1
- B. 10
- C. 100
- D. 1,000

12. $8\frac{1}{9} \div \frac{5}{8} =$

- A. $6\frac{41}{54}$
- B. $7\frac{5}{18}$
- C. $8\frac{2}{15}$
- D. $9\frac{11}{15}$

2²10²

8

13. Simplify.

$$2(3) + 4 + 2$$

- A. 7
- B. 8
- C. 9
- D. 10

14. Simplify.

$$10 + 2 - 4 \times 3$$

- A. -7
- B. 3
- C. 7
- D. 15

15. Simplify.

$$(35y - 12) - (11y - 40)$$

- A. $52y$
- B. $24y + 28$
- C. $24y + 52$
- D. $46y + 52$

16. If $8b = 56$, which inverse operation will find b ?

- A. addition
- B. subtraction
- C. multiplication
- D. division

17. $\sqrt{68}$ is approximately equal to

- A. 8.25
- B. 16.50
- C. 18.25
- D. 32.00

18. The prime factors of 720 are _____.

- A. 2, 3, and 5
- B. 2, 3, and 120
- C. 5, 9, and 16
- D. 5 and 12

19. The prime factors of 24 are _____.

- A. 1 and 3
- B. 2 and 3
- C. 3 and 7
- D. 4 and 6

20. If $8(n - 5) = 27$, then $n =$

- A. $2\frac{3}{4}$
- B. 4
- C. $8\frac{3}{8}$
- D. 67

21. $0.715 \times 11 =$

- A. 7.865
- B. 10.285
- C. 11.715
- D. 78.65

22. Simplify.

$$(24 + x) + 8$$

- A. $x + 8$
- B. $x + 16$
- C. $x + 24$
- D. $x + 32$



8

23. If $\frac{3n}{5} = 81$, then $n =$

- A. $16\frac{1}{5}$
- B. 27
- C. $48\frac{9}{5}$
- D. 135

24. If $3r - 9 = -15$, then $r =$

- A. -3
- B. -2
- C. 2
- D. 3

25. $\sqrt{42}$ is approximately equal to

- A. 0.42
- B. 2.80
- C. 4.20
- D. 6.48

26. $3\frac{2}{5} \times 7\frac{1}{2} =$

- A. $10\frac{9}{10}$
- B. $21\frac{1}{5}$
- C. $21\frac{9}{10}$
- D. $25\frac{1}{2}$

27. Simplify.

$(34d + 10 - 15d) - (9d - 9 + 4)$

- A. $10d + 5$
- B. $10d + 15$
- C. $15d$
- D. $28d + 5$

28. Simplify.

$\frac{2}{5} - \frac{3}{5}\left(\frac{10}{9} + 20\right)$

- A. -20
- B. $-13\frac{1}{9}$
- C. $-12\frac{4}{18}$
- D. $-11\frac{1}{3}$

29. If $3(x + 2) + 2x = 21$, then $x =$

- A. 2
- B. $2\frac{2}{5}$
- C. 3
- D. $3\frac{4}{5}$

30. If $7(3x - 7) + 4x = 2(5x + 3) + 20$, then $x =$

- A. 1
- B. $2\frac{1}{7}$
- C. $4\frac{2}{5}$
- D. 5

31. Sajj wants to carpet this living room floor.

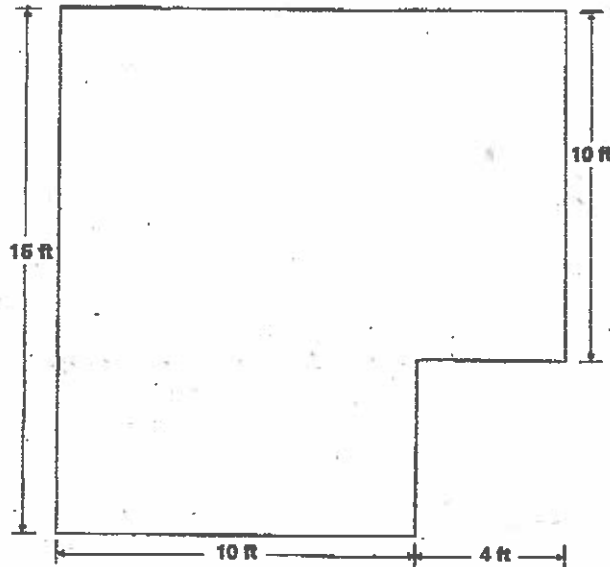

How many square feet of carpet will he need to cover the floor?

- A. 40
- B. 58
- C. 150
- D. 190

32. The graph shows the weekly sales averages for the Gear and Gadgets Company for the past nine weeks.

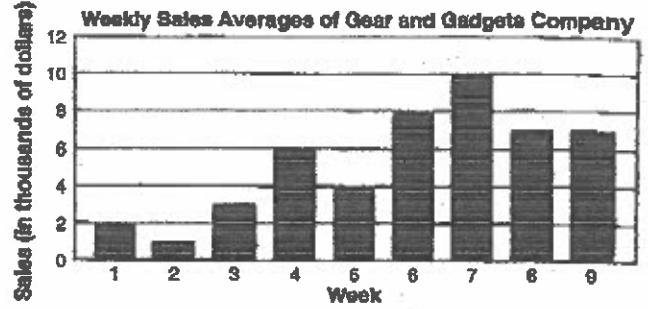

What is the median for these weekly averages?

- A. \$4,000
- B. \$5,000
- C. \$6,000
- D. \$7,000

33. Kevin is rolling a cube that has numbers (1-6) printed on its sides. What is the probability that he will roll a 4?

- A. $\frac{1}{6}$
- B. $\frac{1}{4}$
- C. $\frac{4}{6}$
- D. $\frac{5}{6}$



8

34. This is a sketch of a skateboard ramp that Justin wants to build.

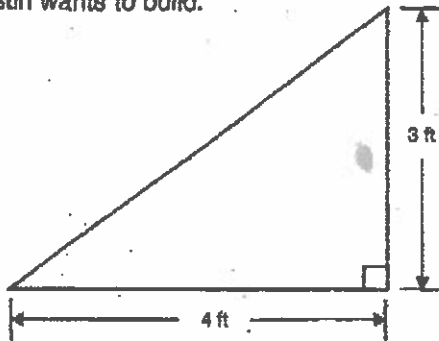

If the ramp will be 3 feet above the ground and have a 4-foot base, how long will the ramp be?

- A. 3 feet
- B. 5 feet
- C. 8 feet
- D. 10 feet

35. Jim bought salmon that cost \$4.95 per half pound. If he spent \$23.95, how many pounds of salmon did he buy? Round off to the nearest tenth of a pound.

- A. 2.3
- B. 2.4
- C. 4.0
- D. 4.8

36. A road map has a scale of $\frac{1}{2}$ inch for 75 miles. The distance between two cities is 600 miles. How many inches apart are they on the map?

- A. 4
- B. 5
- C. 8
- D. 37.5



**IF YOU FINISH BEFORE TIME IS UP, YOU MAY CHECK YOUR WORK IN THIS SECTION ONLY.
DO NOT LOOK BACK AT ANY OTHER SECTIONS IN THIS BOOKLET.**

Gr. 8 (FORM B) Math Answer Keys

Part A: Math Computation

- | | | | |
|------|------|------|------|
| 1.B | 11.C | 21.A | 31.D |
| 2.C | 12.D | 22.D | 32.C |
| 3.B | 13.B | 23.D | 33.A |
| 4.B | 14.A | 24.B | 34.B |
| 5.D | 15.B | 25.D | 35.B |
| 6.C | 16.D | 26.D | 36.A |
| 7.D | 17.A | 27.B | |
| 8.B | 18.A | 28.C | |
| 9.A | 19.B | 29.C | |
| 10.C | 20.C | 30.D | |

Gr. 8

$$\begin{array}{r} 15 \times 10 = 150 \\ 10 \times 4 = 40 \\ \hline 190 \end{array}$$

PEANUTS
Eggs